

# CZECH REPUBLIC



## PASSPORT



**PANORAMA**

GOLF RESORT



PANORAMA GOLF RESORT

**UNIQUE IN EVERY DETAIL**

35 MINS FROM PRAGUE

27 HOLES

PRACTICE AREAS

RESTAURANT

HOTEL

MEETING ROOM

# THE CZECH REPUBLIC TOURISM PASSPORT



SURNAME / NAME

CITY / COUNTRY

Holder's signature

The Expo passport is not an official document.  
The publishers of this passport hope that visitors will use the information  
it contains to make their stay in the Czech Republic.  
This passport contains 44 numbered pages with the most  
beautiful landscapes of the Czech Republic

# Welcome!

The EXPO in Dubai was supposed to go down in history as the first General World Exposition in the Arab world. It is now clear that it will not take place at the turn of 2020 and 2021, but a year later, the United Arab Emirates, however, will retain the organizational primacy of this broadly international spectacle among the Muslim states.

And they will have other firsts as well. Not only in terms of the size of investments in the construction of the exhibition centre and the extensive infrastructure on the sand dunes but also with regard to the unprecedented postponement of the joint venture of one hundred and ninety countries by twelve months. For a whole year that the world will experience as year zero after the spread of the coronavirus SARS-Cov-2 and the pandemic of the COVID-19 disease.

The author of these lines cannot foresee October 2021, when the EXPO is supposed to begin. He has no idea whether all of the current participants will arrive at the World Exposition, or how many visitors will travel to Dubai at the time of the - perhaps already fading - effects of the global epidemic and the

subsequent economic downturn. But he dares to say that the United Arab Emirates will open the gates of the exposition site and that the Czech Pavilion will be ready.

Even today, at a time when some countries have not even started construction, the building of the national pavilion at the EXPO is standing. The permanent exhibits - including the world-renowned S.A.W.E.R. system, which independently produces water from the air using solar energy, creating an oasis in the desert - are either ready or their production is coming to an end. And the authors of ten two-week expositions also confirmed their exhibition ambitions.

These include companies and institutions that were selflessly involved in the fight against the world pandemic, instead of preparing for the World Exhibition: CTU or the 3D printing power Průša Research with several types of respirators. TU Liberec or Nafigate with anti-virus nanofiber masks. Brno University of Technology with a robotic arm handling COVID-19 samples or Žufánek distillery with disinfectants. And more.



Mgr. Jiří František Potužník –  
Commissioner General

They are universities and private companies; they are small and large entities from different parts of the country. But they are united by their extraordinary creative potential, the courage to do something, and a sense of responsibility. That is exactly what fulfils the concept of national participation at the EXPO called „Czech Spring“. And if the exposition includes demonstrations of innovations that have helped fight the unpredictable coronavirus, it will be more for the reputation of our

country than anything PR agencies can come up with.

The World Exposition in Dubai is now set to begin, one hundred and sixty years after Prince Albert hosted the first one in London. He did so by saying that even rival states should cross borders in the fields of industry, science, and the arts. We should keep this in mind, even more so now as viruses and other global threats stopped recognizing borders a long time ago.



# Pavilion Concept

The National Pavilion at the General World Exposition EXPO 2020 in Dubai will be built according to the architectural design of young Czech architects from the company Formosa AA, s. r. o. (Ltd).



Five proposals entered the finals of the tender for the Czech Republic pavilion at the Expo 2020 in Dubai – another five had to be eliminated at the time of submitting preliminary proposals and the

sixth during the submission of competition models.

The expert committee consisting of architects Eva Jiřičná, Miroslav Řepa, Zdeněk Lukeš, Michael Klang,

David Vávra and representatives of the academic, artistic and business communities Tomáš Matuška, Jan Kukla and Radek Špicar were impressed by the winning design – specifically by the original concept of an organic structure growing around the quadratic lines of the exhibition space.

The technological core of the national exposition will be the S.A.W.E.R. system that produces water from the air using solar energy and cultivating the desert using subsurface cultures, which is

being developed by scientists from the ASCR and CTU.

The design of the pavilion reflects the S.A.W.E.R. system. Its essence is transformation. It transforms air into water and dry desert into a blooming garden. The structure is not only a passive decoration, but its individual parts are connected to the S.A.W.E.R. system. It thus becomes an active part of the system it represents.

The pipes, which create a cloud around the exterior, passes into



the interior, where it intersects with other technological components, which also serve a visual purpose. Emphasis is placed on the components of the cultivation system that are located in direct contact with the centre of gravity of the pavilion. Admitting the presence of this technology in the pavilion elevates it to the level of an exhibit.



The Czech Pavilion will be located in the „Sustainability“ zone on a 2,200 square meter plot of land and, like at the Expo 2015 in Milan, it will be the first pavilion at one of the main entrances to the exhibition site. The organizers anticipate that 20 million people will attend the World Exposition, which runs from the 20th of October 2020 until the 10th of April 2021 - 70% of the visitors will come from abroad.

## Rotational Exposition

For the duration of the General World Exposition, the rotating exhibition of the National Pavilion will host by 10 thematic exhibitions that will be oriented into 4 basic blocks: water, design, technology, universities.

Planned theme exhibits in the rotational exhibition

CZECH SPA	100 YEARS OF ROBOT – SMART CITIES
WATER FOR LIFE	MICRO & MACRO
WATER INSPIRATION	ENERGY THE SMART WAY
CZECH TREASURES	CZECH PRIMACY
CZECH DREAM	CZECH UNIVERSUM







## Permanent Exposition

The permanent exhibition consists of ten exhibits.

The first one is an exhibit called Hearth of the Spring - a fountain filled with water running down from organic capillaries made of

the same material as the entwined cloud shielding the garden around the National Pavilion. The S.A.W.E.R system will also be

located on the ground floor of the pavilion. - a device that functionally integrates five Czech patents and innovations from researchers at the Czech Technical University and the Academy of Sciences of the Czech Republic, it produces water from the air using only solar energy and cultivates the desert - a technology capable of creating an oasis in the sand. The functioning of the system will be described in detail by a didactic wall with impressive animations. The water provided by the S.A.W.E.R. system will be used to irrigate the gardens around the National Pavilion.

Visitors will enter the first floor around a monumental installation from LASVIT, designed by Maxim Velčovský. The exhibit called Golden Rain will be made of metal fibres and glass and will combine traditional glass production with modern technologies. The whole installation will consist of dozens of individual golden streams with glass drops inside each of them. The drops will pulse in space using dynamic lighting.

These three exhibits will be complemented by another seven permanent installations. Two

of them will be housed in the rotating exhibition space - an exhibit called Phoenix Energy by Jakub Nepraš, which depicts two layers operating with different meanings - the bottom layer will show the visitor a perception of time and the material sphere upon which civilization depends today. The top layer will show how one should devote himself to the mental sphere and to care for it. This exhibit will be directly followed by an abstract painting by Adéla Oliva entitled Six Elements, which is created under the auspices of the Kroupa Gallery and which shows the balance of the elements and human thinking.

Another part of the pavilion, which will provide space for permanent installations, is the exhibition entitled „The Czech Republic: The Country for the Future“.

That part will be opened by the Prusa 3D Farm - an interactive wall of personal 3D printers from Průša Research, which create three-dimensional elements of a puzzle, assembled in real time by visitors of the pavilion. This will be followed by the 3D Arm - a robotic arm,

created in collaboration between the universities BUT, TBU, and the company Fillamentum, presenting the idea of material sustainability and technological advancement which uses sand and degradable bioplastics from waste fats for 3D printing.

The exhibit directly following the robotic arm is the exhibit We Speak Plantish - a fully automated robotic line from the company PSI that can read how plants react to various conditions and shocks and suggest the appropriate care for them based on the data collected. In the

National Pavilion, visitors will find out how the plants react, for example, to music that they will be able to play on the spot on the glass water organ by Petr Nikl - which is another exhibit called Darkov Waves. This exhibit will be the central element of the relaxation zone as the elevated platform will allow visitors to sit, relax and watch the rest of the exhibition space.

The last internal exhibit is a glass sculpture by Vlastimil Beránek called Venus, which boasts the title of the largest polished glass sculpture in the world.

Pavilion floor plan

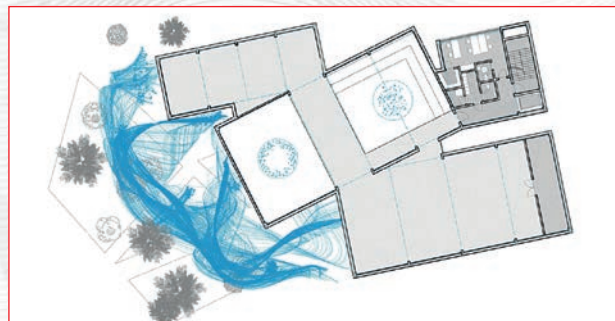



# Solar Air Water Earth Resource (S.A.W.E.R.)

Turning a dry and hot desert into a green landscape is now the stuff of dreams or fairy tales. In practice, large amounts of water would be needed to make such a change. But where in the desert can one find such huge quantities of water? From the air using the Sun! Even desert air contains a small amount of water vapour. But the climate conditions of the desert do not allow for an easy extraction of water from the air with the use of a conventional cooler, that would condense the water with low temperature. That can be done in the European climate conditions, but not in a barren area suffering from water shortage.

A device that can transform the dry desert into an oasis through targeted microorganism reproduction may sound a little bit like a sci-fi story. Research and development, however, rely in part on the scientific-fantastic genre and thus point towards future technologies. Solar Air Water Earth Resource (S.A.W.E.R.) is composed of two systems, one for extracting water out of the desert air and the other for cultivating the desert into fertile land.

The system for the acquisition of water from the air, developed by the University Center of Energy Efficient Buildings and the Faculty of Mechanical

Engineering of the Czech Technical University in Prague, is used as a two-stage system in which a desiccant – a material that binds water to itself through adsorption – is used in the first stage. The desiccant removes the water contained in the outside air and holds it on its surface. The dehumidified air is then taken back outside. At the same time, additional desert air with its natural water content is taken from the outside and heated up to the point, where the water vapour stuck on the surface desiccant is released into the desert air and humidifies it. That is because the heated air can bind

a larger amount of water vapour. This increases the overall humidity of the air reaching the cooler, compared to the humidity of desert air. Thanks to this, a much larger amount of water can be obtained from the air by condensing it on the cooler.

While a conventional cooler can produce an average of 10 l/day from the desert air, the S.A.W.E.R. system is capable of producing up to 200 l/day at comparable air flow rates. A specific ability of the S.A.W.E.R. system is its autonomous operation. The energy needs of the system are fully covered by solar energy (solar photothermic collectors, photovoltaic modules, accumulation of heat and electricity). The two by-products of this technology are hot water used for showering and cool air used for air-conditioning in the building.

The Botanical Institute of the Academy of Sciences of the Czech Republic is developing a desert cultivation system that uses part of the obtained water for a special photobioreactor, an artificial medium used to cultivate microalgae to produce polysaccharides and retain nutrients in the water. A mixture of water, algae and organically bound nutrients is then applied by means of a sealing system located

about 20 cm below the soil surface. Plant roots get the nutritious water directly from a grooving pipeline. By pouring algae-containing water into the soil, nutrients can be slowly released into the earth, as well as other substances contained within the algae, such as plant hormones and organic matter, necessary for the successful growth of plants.

Before planting the plants, the barren sandy soil will be revived by microorganisms that are beneficial for the growth of plants as well as those that facilitate easier nutrients absorption and increase water retention in the soil around the roots. These organisms, soil symbiotic mycorrhizal and endophytic fungi functioning in the root system, in conjunction with other soil organisms, revive the soil so that it becomes suitable for cultivation under such extreme conditions as those found in the desert.

The University Centre for Energy Efficient Buildings (UCEEB) and the Faculty of Mechanical Engineering of the Czech Technical University in Prague are working on the development of the technology S.A.W.E.R. in cooperation with the Botanical Institute of the Academy of Sciences of the Czech Republic.





# Czech Republic

## The Scenic Heart of Europe

People say that the Czech Republic is not a country, it is a garden. To this date the Czech Republic consists of three historical regions Bohemia, Moravia, and Czech Silesia with Bohemia being the largest and the location of Prague, the capital of the country. The Czech basin is situated in the middle of the border-forming chain of mountains covered with deep

forests on hill sides and covered by ponds. Other places are lively and hilly. Throughout the Czech Republic, there are over 40,000 kilometres of hiking trails. One of the most beautiful I've been to is Bohemian Switzerland National Park towards the north of the country. Other places include Šumava lakes and Adršpach- Teplice Rocks. In the East, in the historical Moravian and

Silesian lands, their endless gold coloured fields shine. History provides a plentiful amount of historical cities and towns, castles and palaces, monasteries, churches and cathedrals, real jewels of architecture and urbanism originating in all ages preceding our times. There are so many interesting and unique jewels all over the whole country that it is impossible to see them all in a lifetime.

The Czech Republic invites you also to take in the architecture and design, the cultural scene, the spa industry, gastronomy, history, and the stories of

Czech brand names which are globally renowned to this day – the Škoda and Tatra automotive companies, the Bata footwear group, and traditional producers of glass and fashion jewellery. Sports play a part in the life of many Czechs, who are generally loyal supporters of their favourite teams or individuals. The two leading sports in the Czech Republic are ice hockey and football. Do you want to know the Czech Republic? We would like to invite you to a small sample. The gate is open and you may enter the Land of Wonders and Beauties.

Photos • Czech Tourism







## SLADKÉ CESTOVÁNÍ



WWW.CARLA.CZ



**CARLA spol. s r. o.**

Krkonošská 2850

Dvůr Králové nad Labem 544 01



## ZNÁME CESTU K ÚSPĚCHU

### NABÍZÍME:

Dotační poradenství   **Studie proveditelnosti**  
**Projekty EU**   Optimalizace firemních procesů  
Strategické poradenství   **Rozvoj podnikání**  
**Korporátní finance**   Investiční bankovnictví

### NAŠE SLUŽBY:

#### Dotační poradenství

Nemovitostní, technologické a energetické projekty  
(studie proveditelnosti / due-diligence/  
byznys plán a ekonomické analýzy)

#### Transakční poradenství

Fúze, akvizice, restrukturalizace a podnikové přeměny,  
vypořádání mezi společníky, mezigenerační  
předání a strategické plánování

#### Interim management

Optimalizace firemních procesů a strategie firmy  
prostřednictvím externího pracovníka pro  
oblasti např. obchod nebo finance

#### Corporate Banking

Akviziční a provozní financování, investiční úvěry

Praha · Brno · Olomouc · Ostrava

www.rams.as

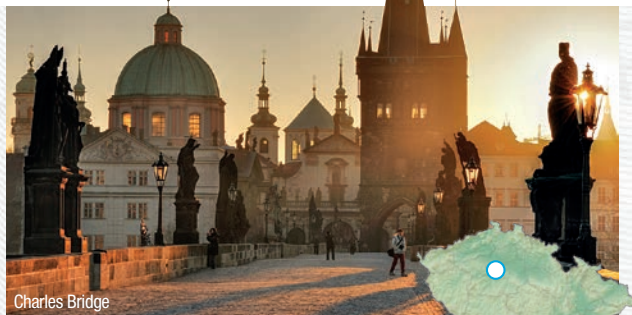

Charles Bridge

## Prague

### Mysterious Mother of Cities

The crown and mother of Czech towns is certainly Prague. It is the city of a thousand spires, one of the most beautiful human settlements on this planet. It's a magical place where the most influential men of Europe have met – sovereigns, commanders, alchemists, Jewish scholars... And precisely in this city, Rabbi Low brought the clay Golem to life. In the past, alchemists tried to produce a philosopher's stone in their melting pots at the Court of Emperor Rudolf II. Franz Kafka wrote his dark and depressing works here. Smetana, Dvorak, and Mozart and Liszt played to excited audiences and received

great ovations. Church reformer Jan Hus preached here, Kopernik, Kepler, Galilei, Giordano Bruno and Tycho de Brahe observed the sky and heavens through their astronomical telescopes here... Prague has simply an atmosphere which cannot be offered by any other city in the world. Let Prague impress you and become an inseparable part of you for at least a moment.

Let's start with one of the most famous places in the Czech Republic, Prague Castle. This is one of the largest castle complexes in Europe and in 1918 it was the seat of Tomáš Garrigue Masaryk who was the first President of the Czechoslovak Republic. Prague Castle is a UNESCO monument with a tradition of more than 1000 years. Prague Castle and St. Vitus Cathedral



Astronomical Clock



National Theatre



Dancing House



Prague Castle



rise above silent statues across the Old Town and Lesser Town full of curved streets and charming squares. Uphill, Prague stands on the Charles Bridge, one of the most beautiful stone bridges in the world. You will find here the time-honoured Vysehrad dominating the Vltava River and its 17 bridges which is the silver pulsating artery of the city, the Old Town with its famous astronomical clock and Wenceslas Square, the true heart of the Czech Republic. Wenceslas Square is the place which the Czechs have always run to at the turning points of Czech history in order to express their will in front of the statue of St. Wenceslas, patron of the Czech nation. On top of Vitkov Hill is the National Monument which is a monument dedicated to the Czechoslovak legions. You will

Photos • Czech Tourism

find here many other historic buildings and jewels of modern architecture from Cubism to Functionalism to the Dancing House. The islands of the Vltava River are an oasis of peace within the vibrant metropolis. Hundreds of museums, galleries and theatres attract visitors to enjoy an extraordinary experience. The distinguished National Theatre built by the Czech nation itself from the money donated by ordinary people is leading this parade.

**Prague Castle:** [www.hrad.cz](http://www.hrad.cz)  
**Old Town:**

[www.staromestskaradnicepraha.cz](http://www.staromestskaradnicepraha.cz)

**National Museum:** [www.nm.cz](http://www.nm.cz)

**National Theatre:**

[www.narodni-divadlo.cz/en](http://www.narodni-divadlo.cz/en)





## Prague Congress Centre goes green

It is not only the city that is pushing for more eco-friendly events but also some of the venues take sustainability seriously. The Prague Congress Centre (PCC) invested already in 2016 in new energy-saving technology, implementing the largest project of its kind in the Czech Republic. The project is run in the form of energy services with savings guarantee (EPC), where costs of modernisation are covered by future energy savings. Today the PCC saves not only electricity, but annually also 11 533 m<sup>3</sup> of water (3 Olympic pools) and 726 tons of CO<sub>2</sub> which

counts for 166,5 hot air balloons filled with CO<sub>2</sub>. The PCC became therefore a suitable venue for all ecologically-minded organizers; it provides comfort in its 20 halls and 50 meeting rooms without an environmental compromise. After recent reconstruction of its premises it offers – apart from the amazing Prague city views – the newest conference technology, digital navigation system and over 300 wi-fi access points. All this is taken care of by an internationally experienced team.

## Prague events are shifting their focus to sustainability

The City of Prague recently launched several sustainable initiatives to make the destination greener. The Prague Convention Bureau has been constantly working on creating a city in which event professionals should want to host and attend events.

The Czech Republic overall is doing very well in meeting the goals of sustainable development, as shown in the UN Sustainable Development Report 2019 that ranked the Czech

Republic seventh out of the total of 162 evaluated countries. What is more the Prague City Council made a commitment to reduce the carbon dioxide emissions by 45% by 2030, and to eliminate them entirely by 2050. The City of Prague also announced that it will stop supporting events at which single-use packagings and dishes are used. Prague thus shows its determination to follow the principles of circular, waste-free economy.





Třebíč

## Beautiful Cities

### Like Pearls on a Ribbon

If Prague is the mother of cities, its children give her credit. For instance, Kutná hora (1) is a city full of cathedrals, monasteries, and patrician houses, arched cellars, jewels of Baroque and Gothic architecture and the art of sculpture, a town with silver mines, the royal mint and one of the most beautiful Gothic cathedrals in Europe dedicated to St. Barbara, as well as the famous Charnel-house with altars, chandeliers, coats of arms and pyramids made of bones and plague epidemic victims. Or, Litomyšl (2),

a renaissance jewel completely filled with music. Litomyšl Castle, a textbook example of the Italian Renaissance and a UNESCO monument was built by Vratislav of Pernštejn between 1568-1581. It is surrounded by picturesque arcades of burgher houses. This is a town which is also world renowned for hosting the opera festival Smetana Litomyšl. Another of Prague's proud daughters is Kromeriz (3), a town full of gardens and parks surrounding the noble Archbishop Palace Chateau that hosts a picture gallery full of masterpieces of the world's paintings. It is simply wonderful to walk in the English park of the Pozdamecka garden of Kvetna garden. Another gem in the necklace decorating the neck of the mother Prague is Telc (4). It is a town

which has a sort of Italian style. There is a nice looking square surrounded by decorated facades of Gothic and Renaissance houses, filigree sgraffito of the palace reflected in the surface of local ponds, perfect cassette ceiling of palace halls, plain beauty of churches, sunny gardens and friendly nature. Or Třebíč (5), with St. Procopius' Basilica, with monumental rosettes and a unique seven hundred-year-old arched crypt and Jewish Quarter with over one hundred and twenty houses,

Town Hall, School, Rabbi's house, Synagogues and large Cemetery with almost three thousand tombstones.

Žďár na Sazavou (6) is also a town worth your attention, namely due to the brilliance of Jan Blazej Santini, virtuoso of Baroque-Gothic architecture. The chapel of St. Jan Nepomucky on Green Hill is unbelievably beautiful, light and airy. His work also includes the local plague cemetery built in the form of a human skull, stables, pub, hospital and monastery prelacey.

**Kutna Hora:** [www.kutnahora.cz](http://www.kutnahora.cz)  
**Litomyšl:** [www.zamek-litomysl.cz/en](http://www.zamek-litomysl.cz/en)  
**Kromeriz:** [www.zamek-kromeriz.cz](http://www.zamek-kromeriz.cz)  
**Třebíč:** [www.zamek-trebic.cz](http://www.zamek-trebic.cz)  
**Telc:** [www.mesto-telc.cz](http://www.mesto-telc.cz)



Žďár nad Sázavou



Kutná Hora

Photos • Czech Tourism



Telc



Kromeriz

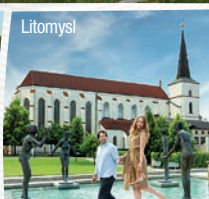

Litomyšl



# Historical Jewels

## Wherever You Look

It is possible that the most beautiful town in Central Europe, built between rocky hillsides, is Cesky Krumlov (1). This is known as a Gothic town of alchemists and stonemasons, conjurers and proud aristocracy crowned by a beautiful Renaissance chateau – the second largest after Prague Castle. Curved lanes lead from the attractive square and their direction is guided

Cesky Krumlov



by the Vltava River which flows through the town and its banks are connected by a number of bridges and foot bridges. It is a labyrinth of proud Renaissance and Gothic houses, gloomy monasteries and proud cathedrals. A visitor who is tired from wandering may sit at the turning auditorium of the theatre, visit some galleries or museums or sit on a boat and look at the town from the surface of the river.

One of the most dominating symbols of the Czech Republic is Karlstejn (2), a monumental and proud stone castle and showpiece of the Czech Gothic architecture. Karlstejn Castle was founded in 1348 by Charles IV, King of Bohemia and Holy Roman Emperor as his private



Karlstejn



Konopiste

residence and a place of safekeeping for royal treasures. It towers on a hill close to Prague. It contains palaces and chambers, long spatial corridors, unconquerable walls and fortified towers. It also houses the most precious jewel, Chapel of the Holy Cross with the unique set of one hundred and twenty nine Gothic desk paintings by Master Theodorik. It is

Photos • Czech Tourism

### Cesky Krumlov:

[www.castle.ckrumlov.cz](http://www.castle.ckrumlov.cz)

### Karlstejn:

[www.hrad-karlstejn.cz](http://www.hrad-karlstejn.cz)

### Konopiste:

[www.zamek-konopiste.cz](http://www.zamek-konopiste.cz)

surrounded by a wonderful park with forests and lakes. Konopiste (3), the castle that excels with rich collection funds and castle collections is one of the rarest in Europe. The last person who transformed the castle according to his own ideas was Franz Ferdinand D'Este, heir of the Emperor Austro-Hungarian throne. Marvellous hunting collections, armouries, pompous parlours and bedrooms, study room and even the private dining room are filled with the spirit of the man whose death in Sarajevo launched World War I.



# visit

## THE ROYAL CENTRAL BOHEMIAN REGION

Central Bohemia 

Discover majestic castles and châteaux, royal towns, unique natural scenery, rich cultural tradition and technical monuments, all in the immediate vicinity of Prague!

 @visitcentralbohemia  centralbohemia.eu

The Central Bohemian Region is interwoven with royal history. On a trip around the region you will find numerous places which have significantly contributed to the development of Czech history. Visit noble castles that once guarded royal treasure, or royal towns associated with the tradition of mining. Climb to the top of church towers and look around the landscape, or make the descent into deep mines, where that most precious of metals, gold, was once mined.

Central Bohemia is an ideal place for active tourists and lovers of virgin countryside. Hiking, bicycle touring and water sports are perfectly suited to the beautiful countryside dotted with rocks, caves and valleys of important Czech rivers. You can choose between a number of physically light or more demanding routes that will take you to charming places.

Those who prefer rest and relaxation will also find something to their liking. You will be treated like royalty in

beautiful château hotels, where the staff will provide wholesome wellness procedures for your tired body, and offer unique culinary experiences.

Discover the beauty of Central Bohemia and enjoy a genuinely royal holiday.



Kokořín



Křivoklátsko



Kutná Hora





## Hidden Gifts of the Czech Lands

The so-called Spa Triangle is the showpiece of the western part of the Czech Republic. The whole country is actually full of spas, but these three towns are simply the most famous of them. The first rank belongs to Karlovy Vary (1), the city of thermal springs situated in a river valley. It is difficult to resist a carefree and festive feeling of peaceful promenade between sumptuous facades of lofty houses and columns of bountifully decorated colonnades. The knowledge that Peter the Great, Maria Terezia, Bach, Goethe, Casanova and Beethoven all drank the same hot healing water from fragile porcelain

cups while standing next to Corinthian columns of marvellous Mlynska colonnade is part of its majestic charm. In addition to beneficial water you should taste the local and famous herbal liquor Becherovka.

All spa towns, as centres of active social life, have grown into more and more beautiful towns and today we can admire cute, shiny buildings in Františkovy Lázně (2) and we can concurrently strengthen our health at the local and oldest peat spa in the world. You will be similarly enchanted by overwhelming peace in elegant, classical pavilions in Mariánské Lázně (3), especially when you know that forty healing springs are available in a small territory of the town and

you will find sixty other springs in the close vicinity.

For Czechs and the whole world, local famous beer is another liquid treasure. People say that Pilsen beer is the country's treasure, but you will find this excellent gold coloured drink with its original taste in every region of the Czech lands and Moravia.

It would be an unforgivable sin to come to Plzeň (4) and not visit our local brewery, not to taste the world famous beer Pilsen. Pilsen, the European Capital of Culture 2015, has an

artistic cheerful spirit and hands it out in fistfuls. Several important theatres, local philharmonic orchestras, galleries, cultural coffee bars, a number of musical theatres and folk festivals are all supplemented by live street art.

### Karlovy Vary:

[www.karlovyvary.cz](http://www.karlovyvary.cz)

### Mariánské Lázně:

[www.marianskelazne.cz](http://www.marianskelazne.cz)

### Františkovy Lázně:

[www.frantiskovylazne.cz](http://www.frantiskovylazne.cz)

**Janské Lázně:** [www.janskelazne.cz](http://www.janskelazne.cz)



Photos • CzechTourism



Jáchymov



Františkovy Lázně



Karlovy Vary



Janské Lázně

# UNESCO sights



Prague



Český Krumlov



Telč



Žďár nad Sázavou



Kutná Hora



Lednice-Valtice Area



Kroměříž



are ageing into beauty



# UNESCO sights



Holašovice



Litomyšl



Olomouc

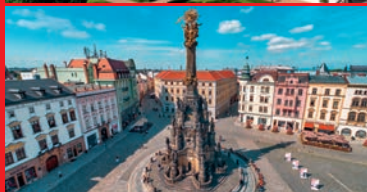

Brno



Třebíč



Erzgebirge/  
Krušnohoří



Kladrby  
nad  
Labem

are ageing into beauty





MARIÁNSKÉ LÁZNĚ • GOLF  
115<sup>th</sup>  
ANNIVERSARY • 1905-2020

**TRUE GOLF HERITAGE**

[www.golfml.cz](http://www.golfml.cz)

**ROYAL GOLF CLUB  
MARIÁNSKÉ LÁZNĚ**

DISCOVER  
THE UNIQUE  
ATMOSPHERE OF THE  
ROYAL SPOON  
RESTAURANT



royal spoon

Come with us  
to celebrate  
115 YEARS anniversary  
& enjoy our modern  
Czech gastronomy  
in comfort of charming  
landscape.

[www.golfml.cz](http://www.golfml.cz)



## Partners of permanent exposition

**Galerie Kroupa**  
[www.galeriekroupa.cz](http://www.galeriekroupa.cz)  
**LASVIT**  
[www.lasvit.com](http://www.lasvit.com)  
**Fillamentum**  
[www.fillamentum.com](http://www.fillamentum.com)  
**Fenix Group**  
[www.fenixgroup.cz](http://www.fenixgroup.cz)

**IQ Structures**  
[www.iqstructures.com](http://www.iqstructures.com)  
**Photon Systems Instruments**  
[www.psi.cz](http://www.psi.cz)  
**Mikrobiologický ústav**  
AV ČR, v. v. i.  
[www.mbcas.cz](http://www.mbcas.cz)

**Crystal Caviar**  
[www.crystalcaviar.eu](http://www.crystalcaviar.eu)  
**Prusa Research**  
[www.prusa3d.com](http://www.prusa3d.com)  
**Lázně Darkov**  
[www.laznedarkov.cz](http://www.laznedarkov.cz)

## Partners of rotational exposition

**CzechTourism**  
[www.visitczechrepublic.com](http://www.visitczechrepublic.com)  
**CONSILIA FUTURA**  
[www.consiliafutura.com](http://www.consiliafutura.com)  
**Swiss Aqua Technologies**  
[www.swatec.ch](http://www.swatec.ch)  
**IQ Structures**  
[www.iqstructures.com](http://www.iqstructures.com)  
**Česká mincovna**  
[www.ceskamincovna.cz](http://www.ceskamincovna.cz)

**Česká televize**  
[www.ceskatelevize.cz](http://www.ceskatelevize.cz)  
**Asociace starožitníků**  
[www.asociace.com](http://www.asociace.com)  
**Ministerstvo průmyslu a obchodu**  
[www.mpo.cz](http://www.mpo.cz)  
**Brno**  
[www.brno.cz](http://www.brno.cz)  
**Jihomoravský kraj**  
[www.kr-jihomoravsky.cz](http://www.kr-jihomoravsky.cz)

**Akademie věd České republiky**  
[www.avcr.cz](http://www.avcr.cz)  
**Sun Drive**  
[www.sundrive.cz](http://www.sundrive.cz)  
**Fenix Group**  
[www.fenixgroup.cz](http://www.fenixgroup.cz)

## Suppliers

**Swiss Aqua Technologies**  
[www.swatec.ch](http://www.swatec.ch)  
**RAKO**  
[www.rako.cz](http://www.rako.cz)  
**Halla**  
[www.halla.cz](http://www.halla.cz)

**EuroClean**  
[www.euroclean.cz](http://www.euroclean.cz)  
**Rolsit**  
[www.rolsit.cz](http://www.rolsit.cz)  
**Dagonet**  
[www.dagonet.cz](http://www.dagonet.cz)

**TALABAYA**  
[www.talabaya.com](http://www.talabaya.com)  
**TONAK**  
[www.tonak.cz](http://www.tonak.cz)

## Partners of restaurant

**Pražská Čokoláda**  
[www.prazskacokolada.cz](http://www.prazskacokolada.cz)  
**Blanka Milfait**  
[www.blanka-milfait.com](http://www.blanka-milfait.com)

**Mattoni 1873**  
[www.mattoni1873.cz](http://www.mattoni1873.cz)  
**Žufánek**  
[www.zufanek.cz](http://www.zufanek.cz)

**Pilsner Urquell**  
[www.pilsnerurquell.com](http://www.pilsnerurquell.com)



# Healing Power of Nature



**ensana**

**Mariánské Lázně**  
**Ensana Health Spa Hotels**

[ensanahotels.com](http://ensanahotels.com)





Czech  
Republic  
The Country  
For The Future